



<https://www.lyonvideo.com>

Office: 614-297-0001

chad@lyonvideo.com

2K-LVE-3 Production & Streaming OB's

VEHICLE SPECIFICATIONS

73' Overall Length, 80,000# GVW
45'L x 8.5'W Expando Trailer
Expandable section 38'L x 5'W
2 - 7.5 ton AC with heaters
Power Requirements:
Three Phase 190-280V
200 amps per leg, 200' Camlocks

CAMERAS & LENS

Wired for 16 HD CCU's

Camera Options Include:

Arri Alexa, Amira
Sony F55, F5, HDC4300
Panasonic Vari cam
Canon EOS
Red
Grass Valley LDX

Lens Options Include:

Funinon, Canon, Arri, Zeiss, Cooke
Panasonic & Marshall PTZ/POV Cameras

Switching & Effects

Grass Valley K Frame 64 inputs, 48 Outputs
7ME, 42 Keyers, 32 GB of Still Store
64 CH of 2D DMP. 16 CH i/eDPM
24 Chromamatte Chroma Keyers
Color Correction, Double Take, ME view
Lance TDC 100 DDR Controller

RECORDING & PLAYBACK

Wired for 24 HD Recording Channels

[24 - 2K Recording Channels]

NOTE: Pick an optional ISO Recording Option
or STREAM to Lyon Video's Media Cloud

K Pro Ultra, Ki Pro Racks, CineDeck, Hyper Deck

EVS Option Includes:

4 6-Channel EVS
EVS X-file, IP Director, Multi Review

Onboard Recording Includes:

1 AJA KiPro Go

Onboard Streaming Includes:

2 AJA Bridge Live
• Includes 4K or Multi-Channel Video Encoding,
Decoding, Streaming & Transcoding

GRAPHICS

Wired for (3) 2-Channel Graphic Machines

Graphic Options Include:

Ross Expression, VizRT, Chyron Mosaic,
Chyron Hyper X3, Pro Presenter
Custom Clock and Score Devices

TERMINAL EQUIPMENT

280 x 458 1080p 3G HD/SDI Video Router
64 x 80 Embed, DeEmbed, 18 FS w/De embed
16 x 16 Fiber I/O, 15-16 Input Multiviewers
1312 x 1696 Audio router
• 1024 x 1024 MADI, 96 x 96 AES
• 192 x 384 Analog
Evertz Magnum Control System w/View
22-72 Button RTR Control Panels
5 CH of For A FA505 Up/Down/Cross Conv.
with Color Correction
4 AJA FS2 Proc's, 10 Teranex 2D Cross converter
4 Evertz A to D's
16 Evertz HD-DA w/down converter
24 Analog audio DA
2 Evertz Sync Generators w/Change Over Switch
Leader Rasterizers/WFM monitors
Sony PVM OLED 17" monitors in video
Hitomi VALID Signal Generator / Reader

COMMUNICATIONS

112 x 112 RTS ADAM Matrix Intercom System
• 32 MADI CH's
• 16 RVON Channels
12 RTS KP 32 Intercom Stations
6 - RTS KP12 Intercom Stations
8 2-Wire Powered PL Channels
6 2-Wire Powered IFB Channels
4 RTS TIFF-2000 Telephone Interfaces
1 Telos One Digital Hybrid
4 Analog "QKT" Phone Couplers
RTS BP325 Intercom Belt Packs
6 RTS 4030 IFB Belt Packs
8 RTS PH88 Lightweight Headsets
9 Beyer DT108 Single Muff Headsets
4 Beyer DT109 Dual Muff Headsets
6 Motorola Two-Way Portable Radios
1 Motorola Base units with RTS Interface

TELEPHONE

Avaya IP500 12 Line Phone System

MISCELLANEOUS

Jimmy Jib w/12-24' Arm
Support Trailer/Green Room
Large LED Monitoring
LED Video Wall
Mics & Audio Equipment
RF PL (Production Line) Bolero, Freespeak
Outboard SAP's, Dante, RTS or IFB "wettters"

AUDIO

CALREC Artemis Bluefin2 Digital Audio Console
• 56 Faders, 6 Layers with A&B Paths
• 240 DSP Channels
• Hydra2 w/H2 (Hydra2 Organizer)
• 64 Mic/Line In x 64 Line Outs
• 256 x 256 MADI IO, 64 x 64 AES IO
2 Fiber Stage Box equipped 24 x 8 Analog IO
• Fiber Stage Box equipped w/Dante/MADI IO
• 16 Stereo Groups or 5.1 Main Outs
• 64 Multi-Track busses
• 16 GPIO's
RTW TM9 Audio Phase Monitor
• Surround Sound Encoder
• Loudness Meter
• Mono to Stereo simulator
JoCo BBR64-MADI 64-Channel Recorder/Player
Genelec Speaker in Audio & Production
Blue Sky Base Management (Production)
1 - 360 Systems Digicart E
Wohler Speaker Stations
2 - Fostex Speakers
[Additional Stage Boxes - Available](#)

MICROPHONES

4 Sennheiser MD46 Microphones
6 Audio Technica AT835st Stereo Shotgun Mics
6 Sennheiser MHK416 Shotgun Microphones
6 Audio Technica Announcer Headsets
2 Daltac Talk Back Boxes
2 Sound Devices Headphone/Mic Preamps

CABLE

2500' SMPTE & Single Mode Fiber
1600' DT12 Audio Mult
1000' 6-Pair Audio Snake
500' 2 Pair Audio Snake
2 - 125' 10 Wire Coax Loom

OUTBOARD MONITORS

9 15" LCD Monitors
2 24" High Rez Monitors
1 HD LCD Test Monitor

rev 12/20/20

2K-LVE-3 Production & Streaming OB's

Floor Plan

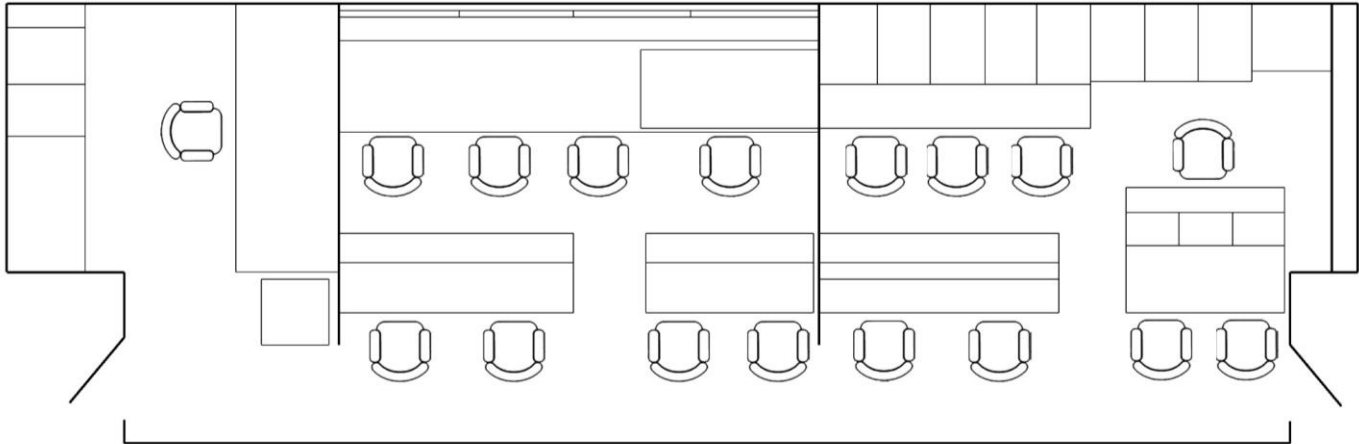

Production Monitor Wall

MONITOR 1A				MONITOR 2A				MONITOR 3A				MONITOR 4A										
										12:00PM												12:00PM
1	2	3	4	1	2	3	4	1	2		3	4	1	2	3	4						
				12:00PM																		
				PROGRAM																		
5	6	7	8			5	6	PROGRAM		PREVIEW										10	11	12
9	10	11	12		7	8	9		10		11		13	14	15	16						

MONITOR 5A				MONITOR 6A				MONITOR 7A				MONITOR 8A				
1	2	3	4	1	2	3	4	1	2	3	4	1	2	3	4	5
5	6	7	8	5	6	7	8	5	6	7	8					
9	10	11	12	9	10	11	12	9	10	11	12	16	12:00PM			S

Representation shown. Monitor Wall is virtual, Each multiviewer can be programmed according to client needs.