



HDX-30

46' HD Expando with C-Band Uplink Capability

Production

Grass Valley K-Frame Switcher Frame
 Grass Valley Kayenne 4-Stripe 35-Button Control Panel w/Aux
 4.5 M/Es, 64 input, 48 output, FlexiKey & Double Take
 (6) Keyers per ME, (16) iDPMs, (2) Chroma Keyers, ImageStore
 Lance TDC100

Camera Equipment

Wired for up to 10 CCUs
 (6) GVG LDX 80 Worldcams 1080p/1080i/720p
 Triax/SM Fiber Camera Basestation w/OCF
 (1) GV LDK8000 Traix/SM Fiber
 SM Fiber Adapters Available
 (4) HH Viewfinders
 (5) 7" Studio LCD Viewfinders
 (2) Canon 86x Long Lenses w/Sleds
 (1) Canon 72x Long Lenses w/Sled
 (2) Canon 21x ENG Lenses
 (1) Canon 11x4.7 Wide Angle Lenses
 Additional Camera/Lens Options Available
 SuperMo Available

Records & Playback

(3) EVS XT3 6-Channel
 (1) EVS XFile 3

Graphics Facilities

Available Chyron Mosaic or Ross Xpression

Terminal Equipment

242x360 NVision NV8280 3G/HD Router
 80x80 Embedding/Dis-Embedding
 GV NV9000 Control System
 170x34 Cobalt 3G/HD Multiviewer
 (20) Cobalt 3G UDC Frame Sync
 Evertz 5600 MSC 3G Sync Generator
 Hitomi Lip Sync Generator
 Image Video TSI-3000

Communications

RTS ADAM-M Digital Matrix 166 x 166 Channels
 96 4-Wire Ports, 64 Omneo CH's, RVON 16
 (12) RTS PL Powered 2W Channels
 (12) RTS IFB Powered 2W Channels
 (4) RTS TIFF 2000 Telephone Interface
 (1) 4 Port Innkeeper QKT Coupler
 (11) RTS BP325 Intercom Belt Paks
 (9) RTS 4030 IFB Belt Paks
 (9) Beyer DT108 Headsets
 (3) Beyer DT109 Headsets
 (6) Two Way Radios

Support

(1) Light Kit
 (4) SDI-HDMI Converters
 (1) HDMI to SDI Converter
 (8) AJA Fido Sets
 (2) Ethernet Media Converters

Satellite Transmission

2.4m AVL C-Band Antenna
 (2) 300-watt Advantech SSP3 Hub-Mounted Amplifier's
 (2) Adtec EN-100 Encoders w/Modulators
 (2) Adtec RD-70 Receivers

Audio Facilities

Calrec Artemis Digital Mixing Console - Bluefin 2 w/Concord
 48 Fader / 240 DSP
 Full 5.1 Surround Sound Capable Mixing
 96x120 Analog, 32x32 AES, 320x320 MADI, 64x64 DANTE
 (2) DigiCart E with RC320 Remote
 (1) CD Player
 Genelec Speakers (Audio/Production)
 Hydra Fiber Audio Booth Kit Available Upon Request

Microphones

(6) Sennheiser HMD25 Announcer Headsets
 (5) Model 210 Talk Back Boxes
 (4) Sennheiser ME66 Shotgun Microphones
 (4) Sennheiser ME67 Shotgun Microphones
 (6) Shure SM58 Stick mics
 (2) Audio Technica BP4029 Stereo Shotgun Microphones
 (4) Sony ECM55 Lavalier Microphones

Outboard Monitors

(5) 15" SDI Monitors
 (2) 21" SDI Monitors

Cable Inventory

6000' Triax Cable
 2100' DT-12 Cable
 (1) 1000' TAC-12 Fiber Mult
 (1) 500' TAC-4 Fiber Mult

Power Requirements

1 Phase, 200 Amps, 208 Volts
 2 Hot Legs, 1 Ground, (No neutral required)
 150' feeder cable with camlock connectors

Truck Dimensions

GVW - 80,000 Lbs
 Dimensions - 46' L, 21' W, 13.5' H working footprint
 22ft H with dish deployed

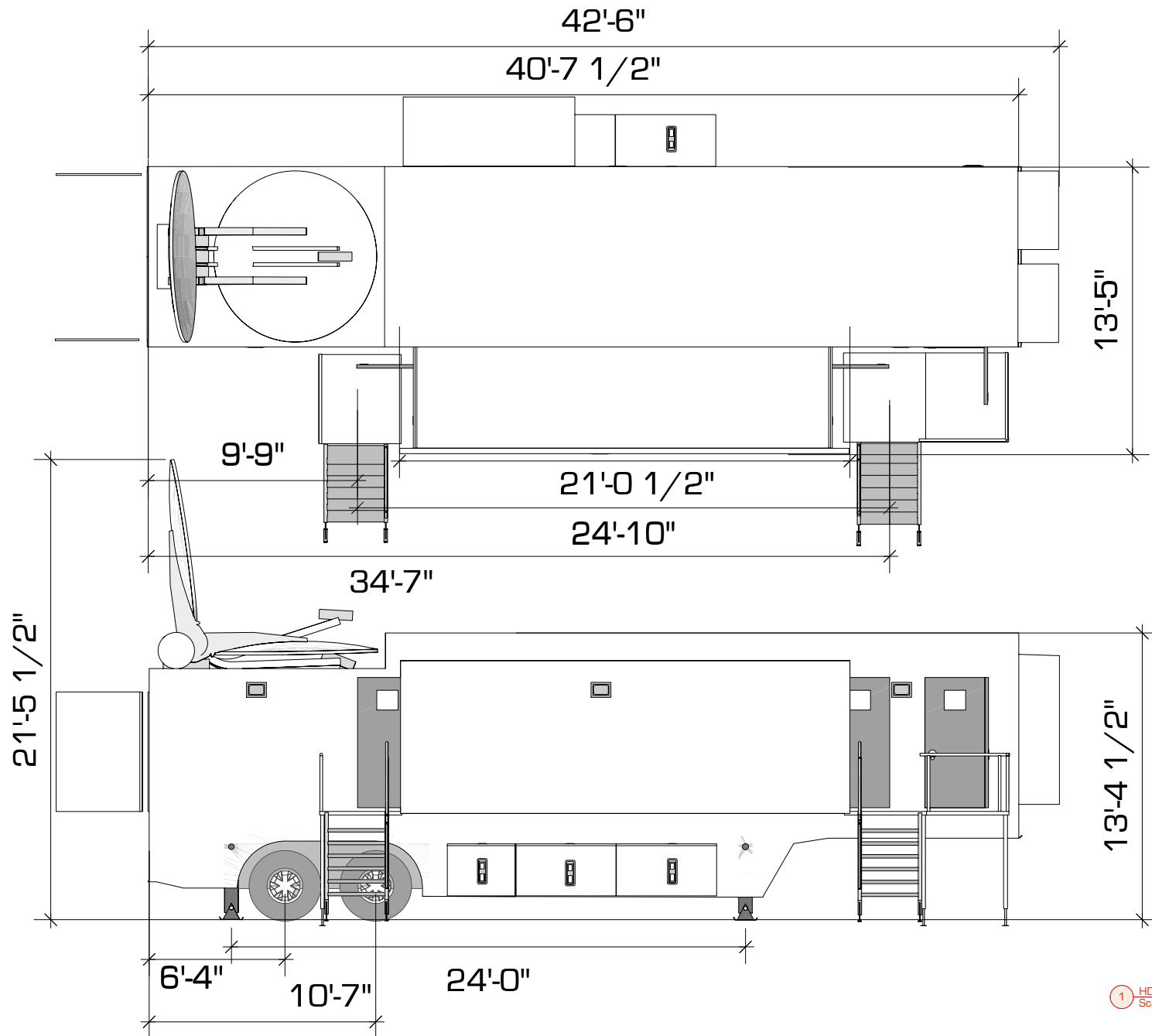

① HDX-10 LMG 3D 2020
Scale: 1:26

<p>LMG 515 Brick Church Park Drive Nashville TN 37207</p>	
<p>LMG HDX-10 HYBRID SAT/PRODUCTION</p>	
<p>HDX-10 LMG</p>	
<p>FILE: HDX-10 LMG 3D 2020.wrk PRODUCTION DRAWINGS BY: Joseph Foster</p>	
<p>SHEET INFO: HDX-10 LMG DIMENSION SET</p>	
<p>NOTES:</p>	
<p>UPDATED: Date: 3/30/20 Time: 10:43:34 AM Ver.001</p>	

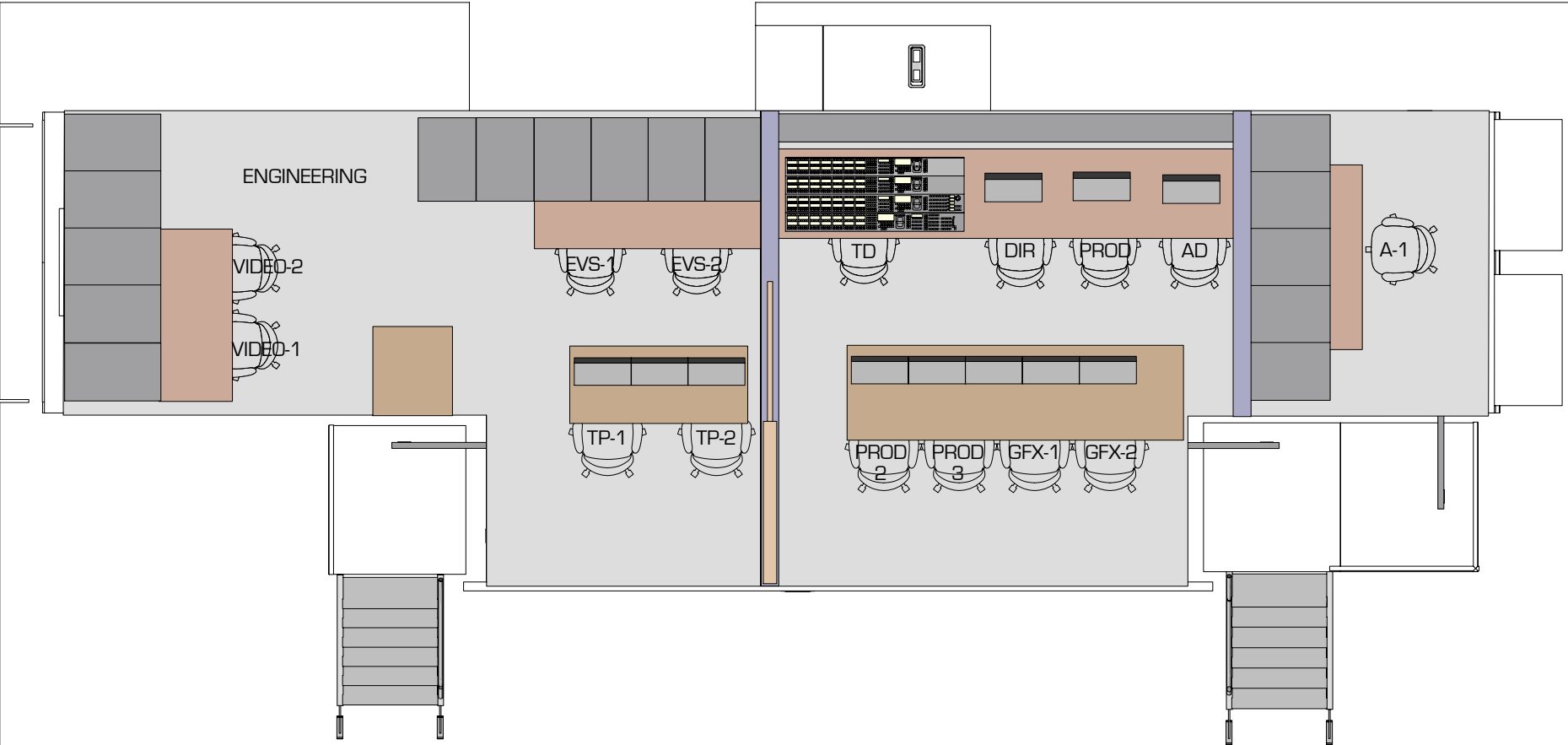

#	LOCATION	NAME:
1	SHADER-2	
2	SHADER-1	
3	EVS-1	
4	EVS-2	
5	TP-1	
6	TP-2	
7	TD	
8	DIR	
9	PROD	

#	LOCATION	NAME:
10	AD	
11	PROD-2	
12	PROD-3	
13	GFX-1	
14	GFX-2	
15	A-1	

3 HDX-10 LMG 3D 2020
Scale: 1:17

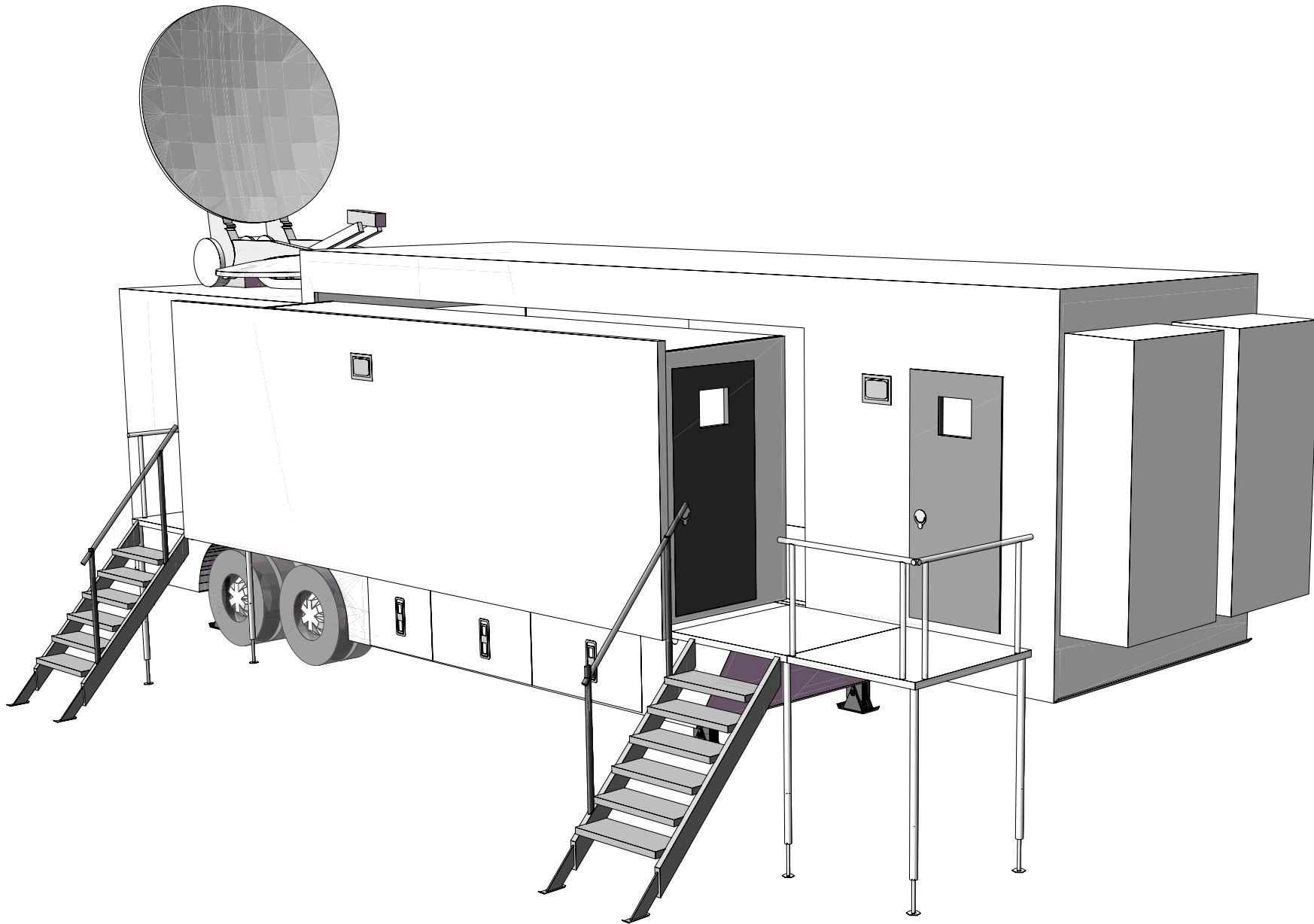

4 HDX-10 LMG 3D 2020
Scale: 1:15

LMG
LIVE MOBILE GROUP

TNDV
TELEVISION

coastal media
GROUP

tvtruck.tv
Harb Production Services

LMG
515 Brick Church Park Drive
Nashville TN 37207

**LMG HDX-10
HYBRID
SAT/PRODUCTION**

HDX-10 LMG

FILE: HDX-10 LMG 3D 2020.rvt

PRODUCTION DRAWINGS BY: Joseph Foster

SHEET INFO:
HDX-10 LMG
ISOMETRIC VIEW

NOTES:

UPDATED:
Date: 4/29/20
Time: 8:28:47 AM
Ver.001

Live Mobile Group HDX-10

SHOW _____ DATE _____

1-1	1-2	1-3	3-1	3-2	3-3	5-1	5-2	5-3	7-1	7-2	7-3
1-4	1-5	2-1	3-4	4-1		5-4		6-1	7-4	7-5	8-1
2-2	2-3	2-4	3-5					6-2	8-2	8-3	8-4
MV 1/2			MV 3/4			MV 5/6			MV 7/8		
9-1	9-2	9-3	11-1	11-2	11-3	13-1	13-2	13-3	15-1	15-2	15-3
9-4	9-5	10-1	11-4	11-5	12-1	13-4	13-5	14-1	15-4	15-4	16-1
10-2	10-3	10-4	12-2	12-3	12-4	14-2	14-3	14-4	16-2	16-3	16-4
MV 9/10			MV 11/12			MV 13/14			MV 15/16		

Technical Director
Director
Producer
AD-1

CCU 01 -	FSY 01 -	FSY 13 -	EVS 1-1 -	AUX 01 -
CCU 02 -	FSY 02 -	FSY 14 -	EVS 1-2 -	AUX 02 -
CCU 03 -	FSY 03 -	FSY 15 -	EVS 2-1 -	AUX 03 -
CCU 04 -	FSY 04 -	FSY 16 -	EVS 2-2 -	AUX 04 -
CCU 05 -	FSY 05 -	FSY 17 -	CG A-1 -	AUX 05 -
CCU 06 -	FSY 06 -	FSY 18 -	CG A-2 -	AUX 06 -
CCU 07 -	FSY 07 -	FSY 19 -	CG B-1 -	AUX 07 -
CCU 08 -	FSY 08 -	FSY 20 -	CG B-1 -	AUX 08 -
CCU 09 -	FSY 09 -	DECODE 1 -	SPOT 1 -	ME 1 -
CCU 10 -	FSY 10 -	DECODE 2 -	SPOT 2 -	ME 2 -
	FSY 11 -		SPOT 3 -	ME 3 -
	FSY 12 -		SPOT 4 -	ME 4 -



LMG
515 Brick Church Park Drive
Nashville TN 37207

**LMG HDX-10
HYBRID
SAT/PRODUCTION**

HDX-10 LMG

FILE: HDX-10 LMG.30202001.wk
 PRODUCTION DRAWINGS BY: Joseph Foster

SHEET INFO: HDX-10 LMG MONITOR WALL

NOTES:

UPDATED:
Date: 3/30/20
Time: 10:43:41 AM
Ver.001

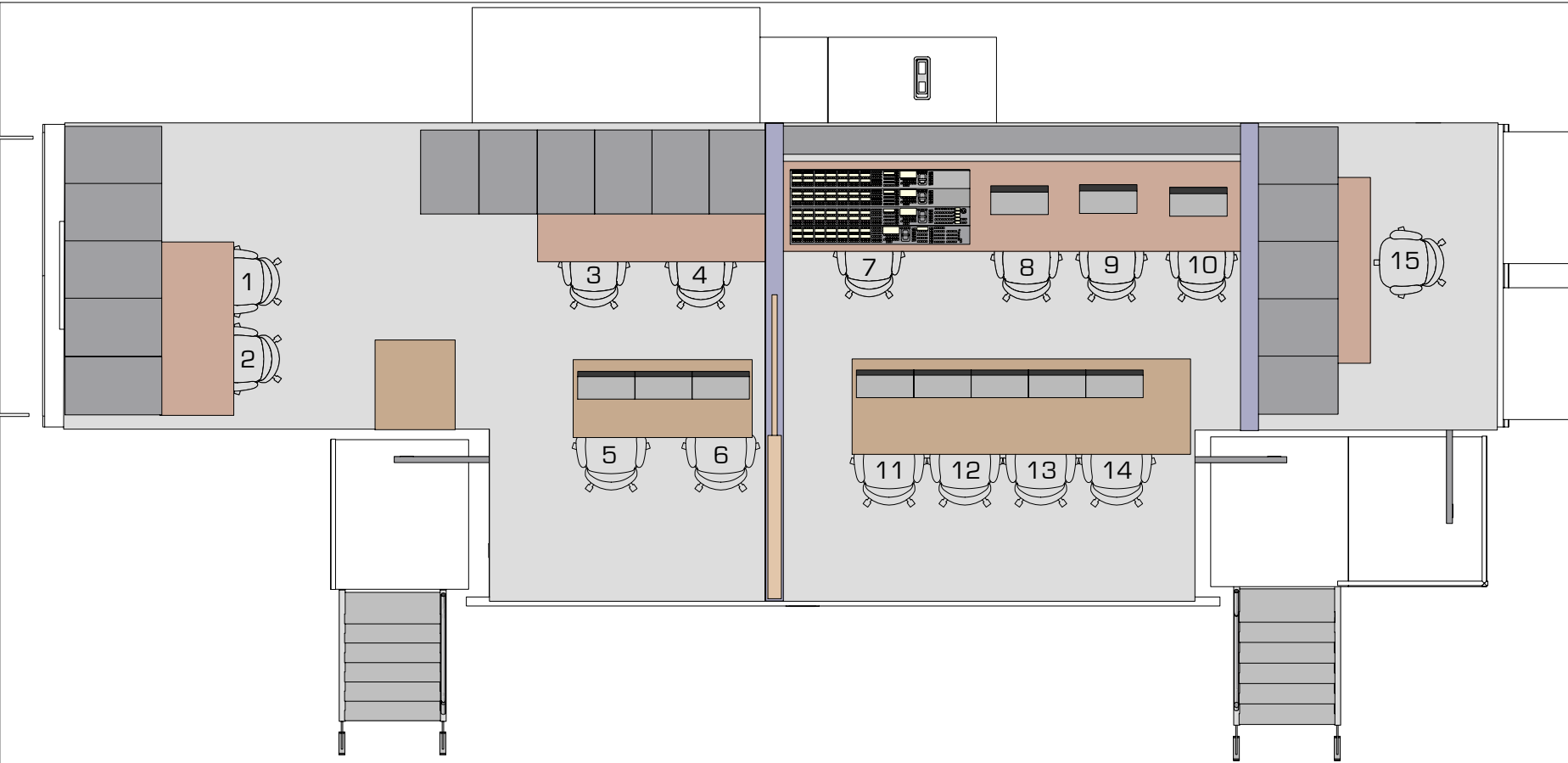

PRODUCTION SEATING ASSIGNMENTS

1	
2	
3	
4	
5	
6	
7	
8	
9	

10	
11	
12	
13	
14	
15	

2 HDX-10 LMG 3D 2020
Scale: 1:17